

High-performance industrial luminaire. Some versions have more than 170 lm/W.

Aluzinc housing and endcaps. Metallised aluminium reflector. Equipped with diffusionplate which effectively reduces glare.

Very flexible due to several different lightdistributions and luminous outputs. From 5000 lm up to over 21000 lm. Wide beam (W), medium beam (M) and narrow beam (N) for aisles and high ceilings. Connected without tools through openable lid and dual glands. 5x2.5 mm² throughwiring as standard.

Mounted by wire, rails or flush to ceiling. Integrated wirebrackets which fold out from the housing. Accessories include several versions of clasps for different roof systems and sportshall systems.

Also available in 5-pole and 2-pole quick coupling with adapted cable or earthed plug for the next fixture (c/c measurements must be specified). Can also be provided with AirC-sensor.

Equipped with robust industrial driver with high resilience against power surges. Adjustable version with Touch-Dim, Dali and corridor function (TDC). Can also be provided with Ra 90 up to 6500K.

Lifetime L80 Ta25 100000h (B50)
MacAdam 3 SDCM CRI: >80 | CE
Energyclass (LED module): D

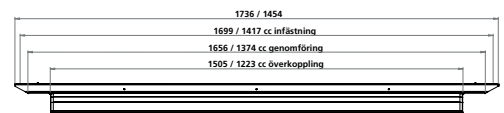
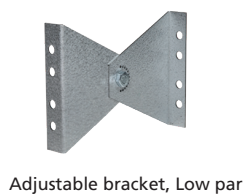
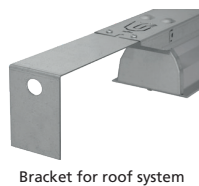
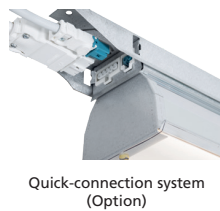
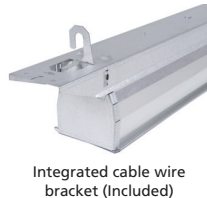

Narrow beam Medium beam Wide beam

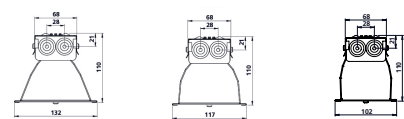

Narrow beam (N) Medium beam (M) Wide beam (W)

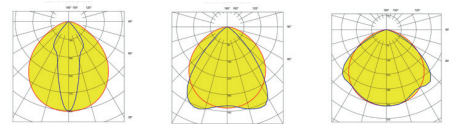

Accessory	Art no.	E no.
Sports hall systems 1200 mm	9 554 51	72 139 75
Sports hall systems 1500 mm	9 554 53	72 139 76
Bracket for roof system (pair)	9 550 57	-
KBA rail bracket (pair)	9 554 16	72 139 77
KBB rail bracket (pair)	9 554 17	72 139 78
Adjustable bracket (pair)	9 550 18	79 550 19
Adjustable bracket, Low par	9 550 19	79 104 43

Narrow beam (N)

Narrow beam (N)	Lumen	Art no.	E no.	L	W	H	c/c	Power	Weight
ID 40 7000 S 840	7200	452803	7218895	1454	132	110	1417	45	3
ID 40 7000 S 840 TDC*	7200	452827	7218897	1454	132	110	1417	45	3
ID 40 9000 S 840	9230	452815	7218911	1736	132	110	1699	57	4
ID 40 9000 S 840 TDC*	9230	452839	7218916	1736	132	110	1699	57	4
ID 40 11000 S 840	10950	452882	7218912	1736	132	110	1699	72	4
ID 40 11000 S 840 TDC*	10950	452885	7218917	1736	132	110	1699	72	4
ID 40 14000 S 840	14280	452922	7218896	1454	132	110	1417	89	3,5
ID 40 14000 S 840 TDC*	14280	452925	7218898	1454	132	110	1417	89	3,5
ID 40 15000 S 840	15320	452961	7218913	1736	132	110	1699	93	4,5
ID 40 15000 S 840 TDC*	15320	452964	7218918	1736	132	110	1699	93	4,5
ID 40 18000 S 840	18150	452887	7218914	1736	132	110	1699	113	4,5
ID 40 18000 S 840 TDC*	18150	452990	7218919	1736	132	110	1699	113	4,5
ID 40 21000 S 840	21080	452942	7218915	1736	132	110	1699	136	4,5
ID 40 21000 S 840 TDC*	21080	452945	7218920	1736	132	110	1699	136	4,5

Medium beam (M)

Medium beam (M)	Lumen	Art no.	E no.	L	W	H	c/c	Power	Weight
ID 40 5000 M 840	5160	452855	7218899	1454	117	110	1417	32	3
ID 40 5000 M 840 TDC*	5160	452863	7218902	1454	117	110	1417	32	3
ID 40 7000 M 840	7100	452807	7218900	1454	117	110	1417	45	3
ID 40 7000 M 840 TDC*	7100	452831	7218903	1454	117	110	1417	45	3
ID 40 9000 M 840	9070	452819	7218921	1736	117	110	1699	57	4
ID 40 9000 M 840 TDC*	9070	452843	7218926	1736	117	110	1699	57	4
ID 40 11000 M 840	10970	452888	7218922	1736	117	110	1699	72	4
ID 40 11000 M 840 TDC*	10970	452891	7218927	1736	117	110	1699	72	4
ID 40 14000 M 840	14250	452928	7218901	1454	117	110	1417	89	3,5
ID 40 14000 M 840 TDC*	14250	452931	7218904	1454	117	110	1417	89	3,5
ID 40 15000 M 840	15300	452968	7218923	1736	117	110	1699	93	4,5
ID 40 15000 M 840 TDC*	15300	452971	7218928	1736	117	110	1699	93	4,5
ID 40 18000 M 840	18200	452982	7218924	1736	117	110	1699	113	4,5
ID 40 18000 M 840 TDC*	18200	452985	7218929	1736	117	110	1699	113	4,5
ID 40 21000 M 840	20980	452948	7218925	1736	117	110	1699	136	4,5
ID 40 21000 M 840 TDC*	20980	452951	7218930	1736	117	110	1699	136	4,5

Wide beam (B)

Wide beam (W)	Lumen	Art no.	E no.	L	W	H	c/c	Power	Weight
ID 40 5000 B 840	5020	452851	7218905	1454	102	110	1417	32	3
ID 40 5000 B 840 TDC*	5020	452859	7218908	1454	102	110	1417	32	3
ID 40 7000 B 840	6930	452811	7218906	1454	102	110	1417	45	3
ID 40 7000 B 840 TDC*	6930	452835	7218909	1454	102	110	1417	45	3
ID 40 9000 B 840	8910	452823	7218931	1736	102	110	1699	57	4
ID 40 9000 B 840 TDC*	8910	452847	7218936	1736	102	110	1699	57	4
ID 40 11000 B 840	10770	452894	7218932	1736	102	110	1699	72	4
ID 40 11000 B 840 TDC*	10770	452897	7218937	1736	102	110	1699	72	4
ID 40 14000 B 840	13850	452934	7218907	1454	102	110	1417	89	3,5
ID 40 14000 B 840 TDC*	13850	452937	7218910	1454	102	110	1417	89	3,5
ID 40 15000 B 840	14860	452975	7218933	1736	102	110	1699	93	4,5
ID 40 15000 B 840 TDC*	14860	452978	7218938	1736	102	110	1699	93	4,5
ID 40 18000 B 840	17540	452995	7218934	1736	102	110	1699	113	4,5
ID 40 18000 B 840 TDC*	17540	452998	7218939	1736	102	110	1699	113	4,5
ID 40 21000 B 840	20330	452954	7218935	1736	102	110	1699	136	4,5
ID 40 21000 B 840 TDC*	20330	452957	7218940	1736	102	110	1699	136	4,5

* Equipped with amplitude-dimmable driver for DALI, push-button control and corridor function.